



1/8 Hawthorn Place Mardi NSW

3 1 2

Tastefully updated and immaculately presented, this impressive home offers a comfortable floor plan, an excellent location that looks out towards the park and pool and a great opportunity for the home buyer or the investor.

The home features 3 bedrooms, all with built in robes, light and bright open plan living, modern kitchen with dishwasher, main bathroom with bath tub, a private fully fenced yard with a pergola for alfresco entertaining, internal laundry with 2nd toilet and a single lock up garage with remote door and internal entry.

Other notable features include:
 Split system air conditioning in the living area and master bedroom
 A Solar system to keep your energy bills down
 Established gardens with fruit trees.

Price : \$ 650,000
Land Size : 233 sqm
View : <https://www.coastwidefn.com.au/sale/nsw/central-coast-region/mardi/residential/semi-detached/7916245>



David Manuelle
 02 4353 1999



Adrian Simpson
 02 4353 1999

1/8 Hawthorn Place, Mardi

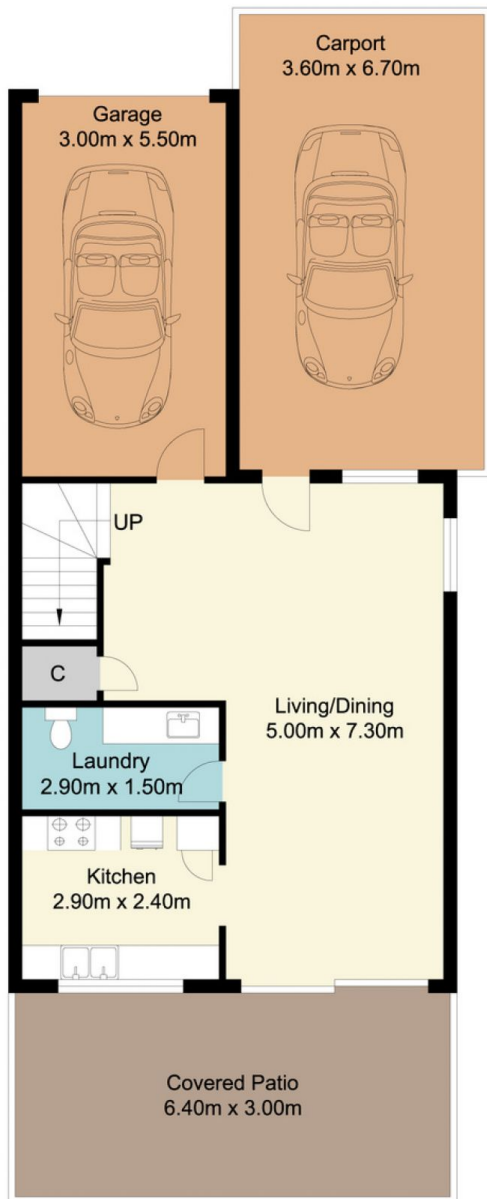

Ground Floor

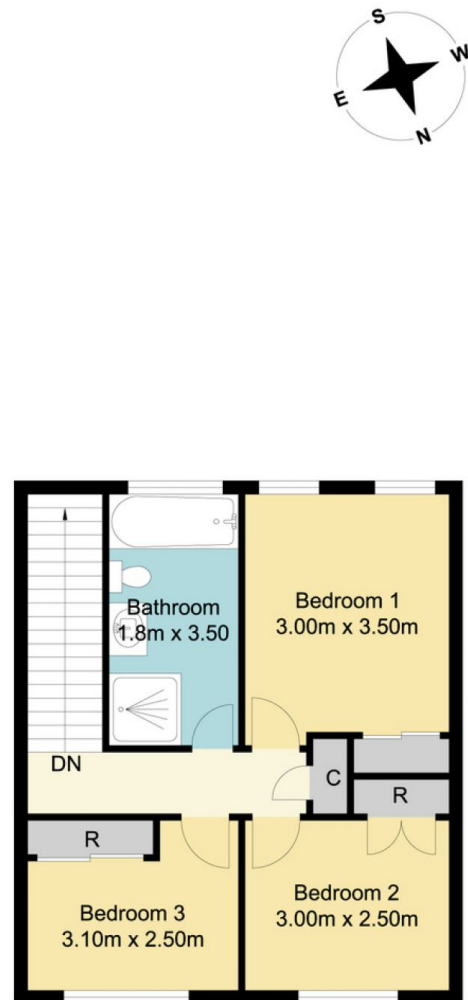

First Floor

Total Approx Floor Area 107.32 sq.m

Measurements are approximate. Not to scale. For illustrative purposes only. Boundaries are approximate

1/8 Hawthorn Place, Mardi

SITE PLAN

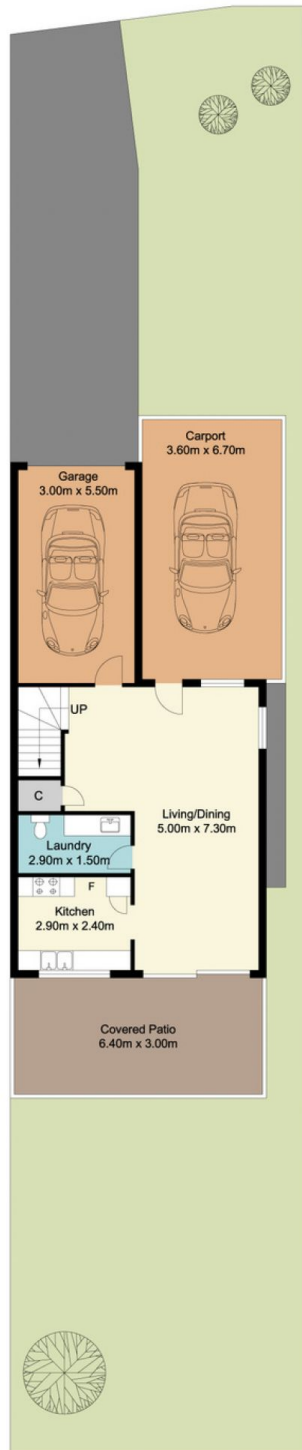

Total Approx Floor Area 107.32 sq.m

Measurements are approximate. Not to scale. For illustrative purposes only. Boundaries are approximate