



55 Playford Road Killarney Vale NSW

3 1 3

Perfectly presented, this delightful single-storey home enjoys a peaceful location and will appeal to both the home buyer and investor.

Located within a short walk to Brooke Avenue Primary School, Eastern Rd Oval and Bateau Bay Square, this home offers 3 bedrooms, a well appointed kitchen, cosy lounge and dining room as well as a modern bathroom with a separate toilet.

A covered entertaining deck at the rear overlooks the fully fenced yard. There is a single drive through garage as well as a separate garage/shed in the backyard.

Complete with landscaped gardens and air conditioning there is no work to be done here, simply move in and enjoy.

Price : \$ 800,000
Land Size : 556.4 sqm
View : <https://www.coastwidefn.com.au/sale/nsw/central-coast-region/killarney-vale/residential/house/7591876>



Adrian Simpson
02 4353 1999



David Manuelle
02 4353 1999



55 Playford Road, Killarney Vale

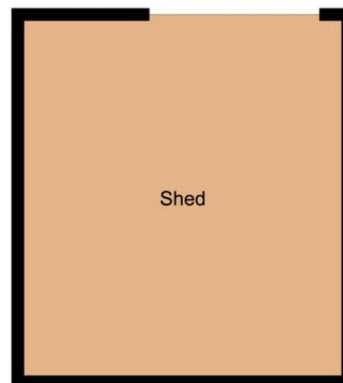

Total Approx Floor Area 126.60 Sq.m

Measurements are approximate. Not to scale. For illustrative purposes only. Boundaries are approximate.



55 Playford Road, Killarney Vale

SITE PLAN



Measurements are approximate. Not to scale. For illustrative purposes only. Boundaries are approximate.