



1365 Mandalong Road Dooralong NSW

1 1

Offering privacy and seclusion this amazing rural holding sits proudly in the picturesque Dooralong Valley.

Boasting 15 acres approx. of prime RU2 land, the property has a sizable clearing in place ready for you to build your dream home (S.T.C.A). The property which is fully fenced has a large rainwater tank plus a good sized dam ensuring all of your water needs are secured.

Stacked with features the shed (160 sqm approx.) has been converted for weekend camping trips and has all the creature comforts. With 2 separate air-conditioned sleeping quarters, kitchen, bathroom and lounge with new slow combustion fireplace this is the perfect weekender.

Conveniently located close to the thriving township of Wyong, Schools, Train Station and Shops are just 15

Price : \$ 1,220,000
Land Size : 15.34 Acres
View : <https://www.coastwidefn.com.au/sale/nsw/central-coast-region/dooralong/residential/land/6877808>



David Want
0402 810 831

<https://www.coastwidefn.com.au>

We sell, rent and manage Real Estate, Residential, Lifestyle and Commercial across the Central Coast



1365 Mandalong Road, Dooralong

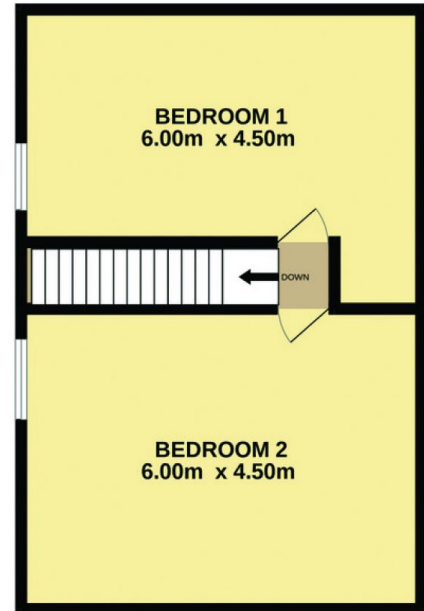

1ST FLOOR
53.9 sq.m. approx.

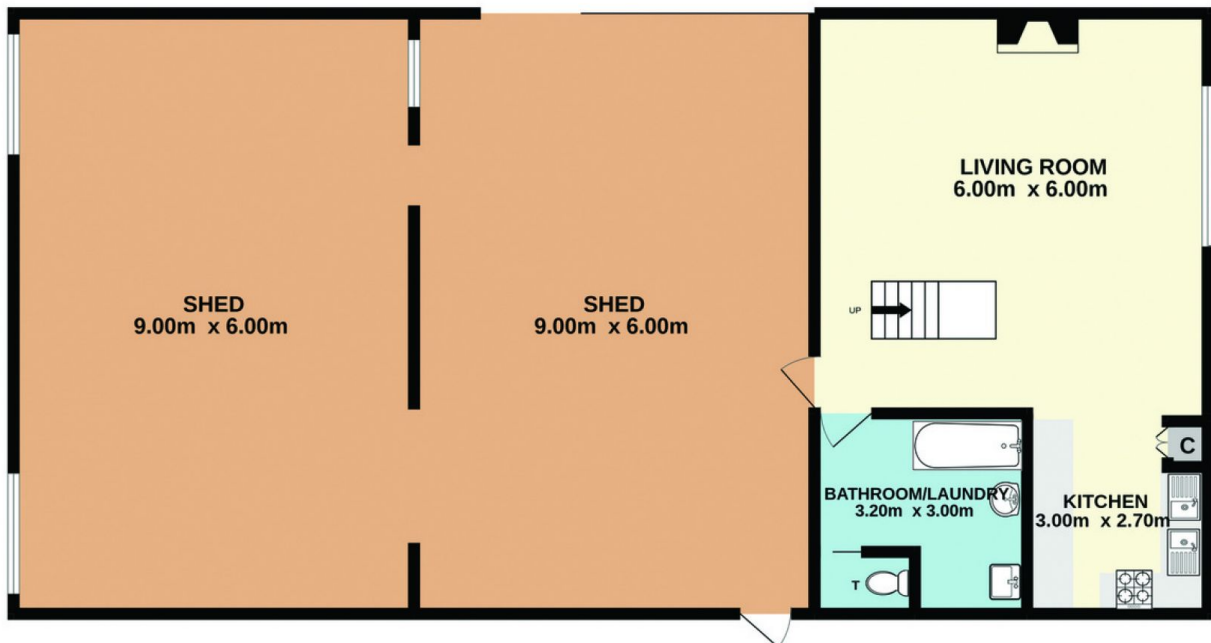

GROUND FLOOR
160.4 sq.m. approx.

Total Approx. Floor Area 214.3 Sq.M.

Measurements are approximate. Not to scale. For illustrative purposes only. Boundaries are approximate.



1365 Mandalong Road, Dooralong

SITE PLAN

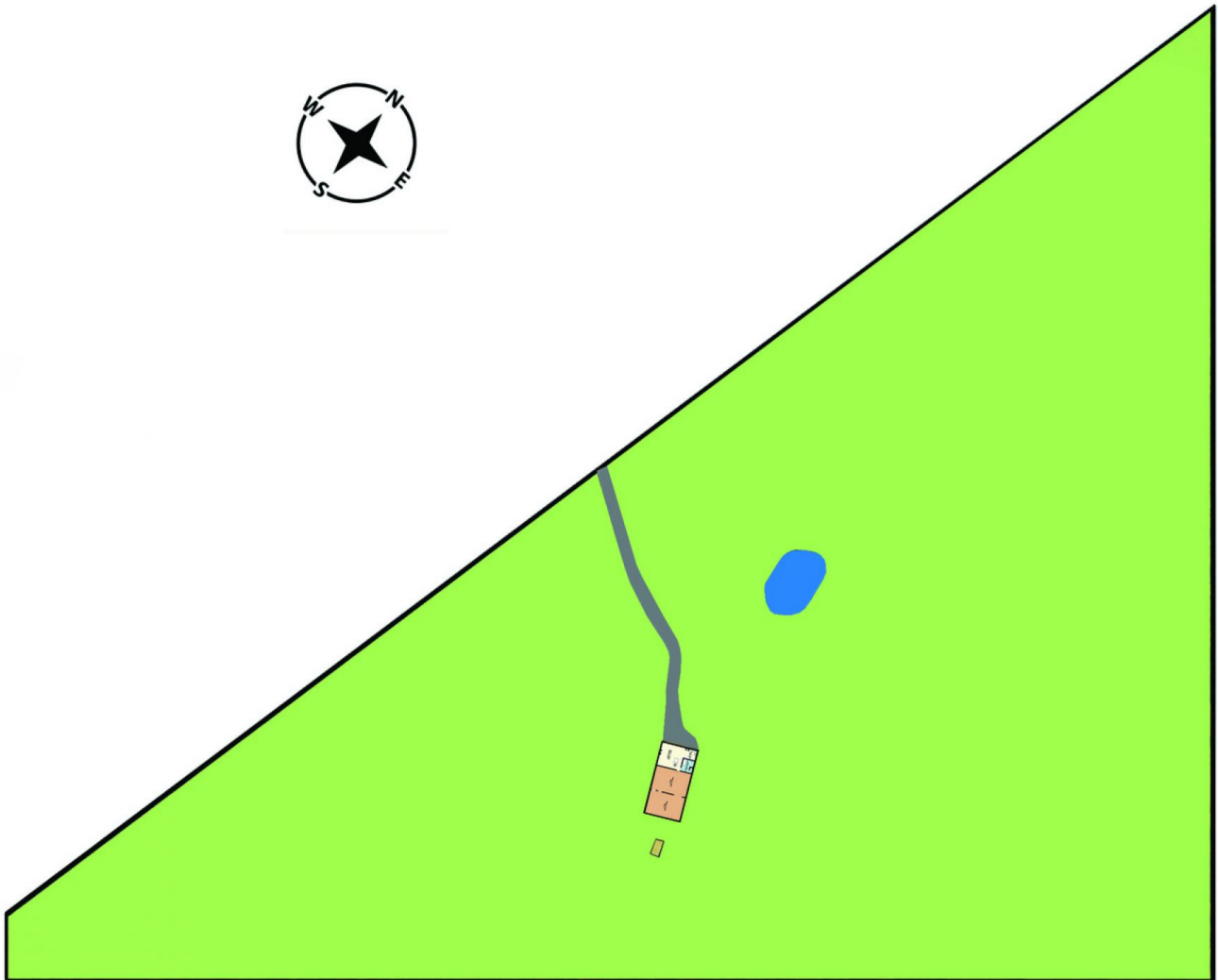

Measurements are approximate. Not to scale. For illustrative purposes only. Boundaries are approximate.