

87 Geoffrey Road Chittaway Point NSW

3 2 3

Perfectly positioned, this fantastic property takes in stunning water views out the front and a picturesque rural outlook out the back.

Having undergone a complete internal makeover, this family home offers an amazing amount of features and that wow factor you have been looking for!

- A full parents retreat with built-in robes, en-suite, living area, kitchenette and views out over the sparkling in ground pool.
- Stunning kitchen with stone bench tops, stainless steel appliances and a dishwasher.
- Hardwood timber floors throughout the living areas and bedrooms 2 & 3.
- Beautiful main bathroom with freestanding bath.
- Enclosed sun room and undercover entertaining area.

Price : \$ 635,000
Land Size : 708.2 sqm
View : <https://www.coastwidefn.com.au/sale/nsw/central-coast-region/chittaway-point/residential/house/5624162>



David Manuelle
02 4353 1999

<https://www.coastwidefn.com.au>

We sell, rent and manage Real Estate, Residential, Lifestyle and Commercial across the Central Coast



87 Geoffrey Road, Chittaway Point

SITE PLAN

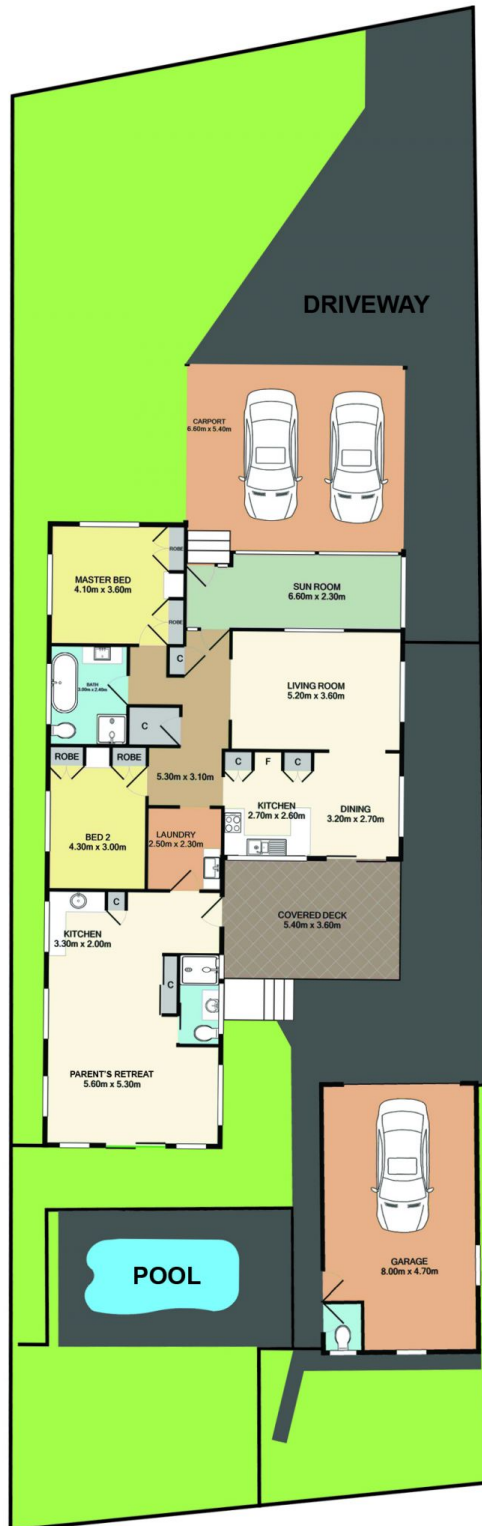

Measurements are approximate. Not to scale. For illustrative purposes only. Boundaries are approximate.



87 Geoffrey Road, Chittaway Point



Total Approx. Floor Area 220.8 SQ.M. 2377 SQ.FT.

Measurements are approximate. Not to scale. For illustrative purposes only. Boundaries are approximate.