



294 Geoffrey Road CHITTAWAY POINT NSW

4 2 4

Looking for a sea change? Look no further. Exclusively located on Geoffrey Road and only one hour North of Sydney, is this stunning deep waterfront property.

Upon entering, you realise how sophisticated and sizeable this home really is. With multiple living areas and a versatile floor plan, you can easily accommodate friends and the extended family. This property boasts a large open plan living and dining areas, large kitchen with stone bench tops with both gas and electric appliances. The large private entertaining deck which comes with a built in BBQ kitchen, is one of many highlights of this property. Others include:-

Price : \$ 1,170,000
Land Size : 967.4 sqm
View : <https://www.coastwidefn.com.au/sale/nsw/central-coast-region/chittaway-point/residential/house/5623520>



Michael Eslick
0402 810 831

Air conditioning.
 Secure 4 car garage with auto roller door.
 Secure workshop.

<https://www.coastwidefn.com.au>

We sell, rent and manage Real Estate, Residential, Lifestyle and Commercial across the Central Coast

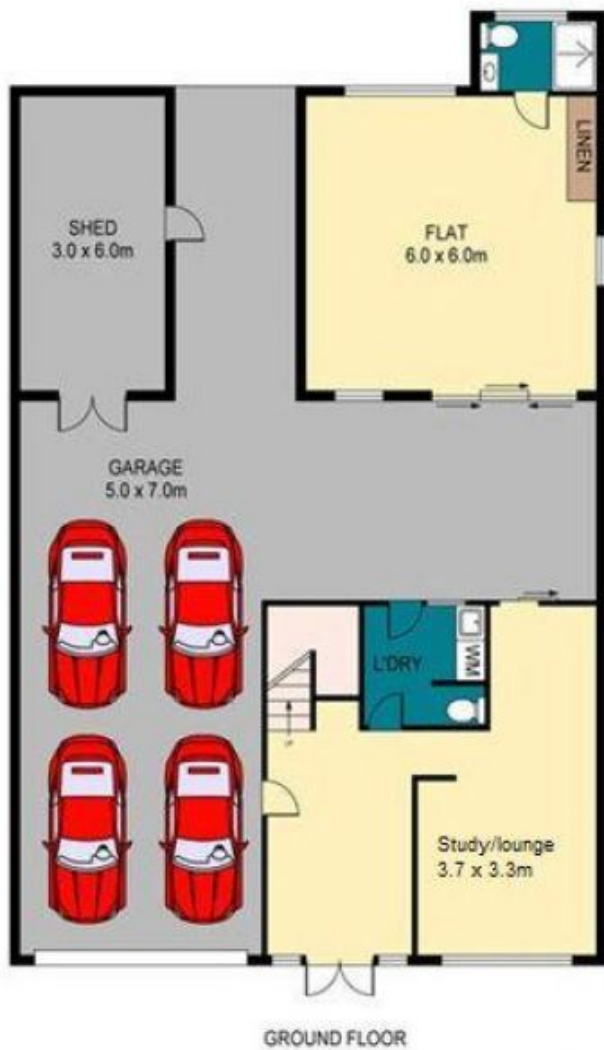

Scale in metres indicative only. Dimensions are approximate. All information contained herein is gathered from sources we believe to be reliable. However we cannot guarantee its accuracy and interested persons should rely on their own enquiries.

294 Geoffrey Road, Chittaway Point