



3/14-16 Alison Road Wyong NSW



Offered for lease is this 87sqm (approx) retail shop perfectly positioned in the popular 'Chapman Building' in the heart of Wyong. Perfectly positioned on Alison Road, the space offers great exposure with large glass frontage, polished timber floors, high ceilings, kitchenette and strong street presence.

Building Size : 87 sqm
View : <http://www.coastwidefn.com.au/lease/nsw/central-coast-region/wyong/commercial/retail/7739751>

There is also two ways to access the property for customer convenience - from the main road street frontage, or from the open grassed area out the back near Glee Coffee Roasters and Jerry Sent Me.

Among other shops in the surrounds are Duck Duck Moose Cafe, Carinya Hair & Beauty, Siem Terrace Thai, and soon to be a fresh Mexican Restaurant.



Adrian Simpson
 02 4353 1999



David Manuelle
 02 4353 1999

This is your opportunity to secure a rare retail space in the

Shop 3/14-16 Alison Road, Wyong

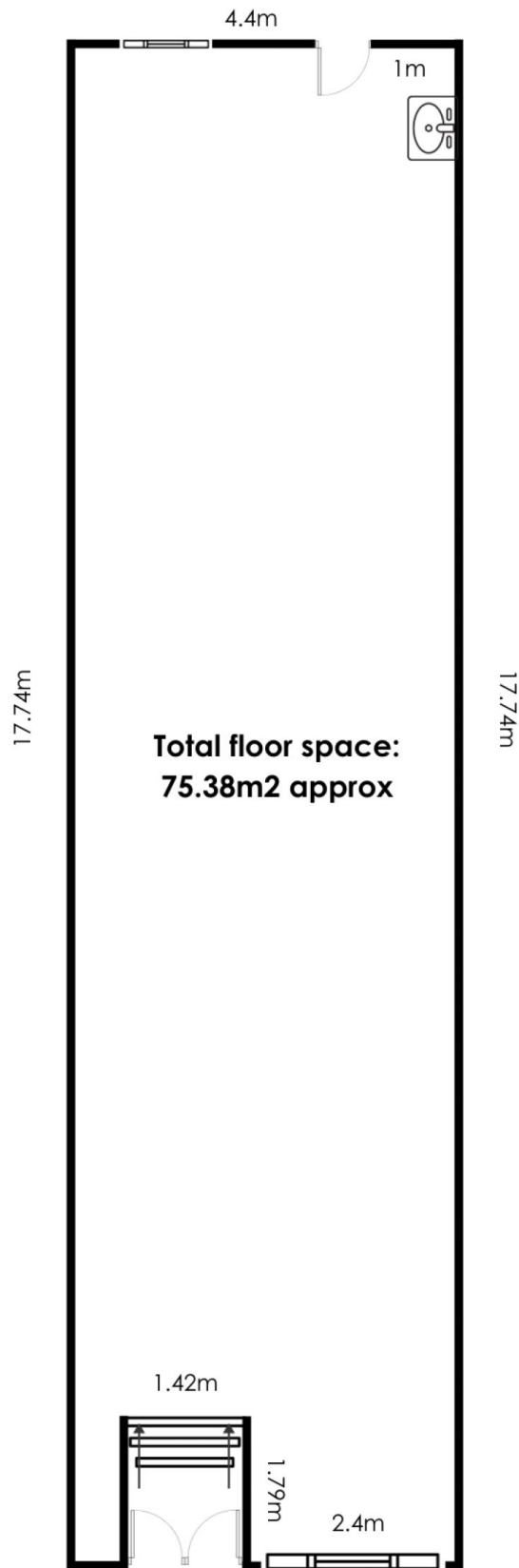

Measurements are approximate. Not to scale. For illustrative purposes only. Boundaries are approximate



firstnational
COMMERCIAL | Coastwide